

7 359 -  
6 21  
380

No 9.

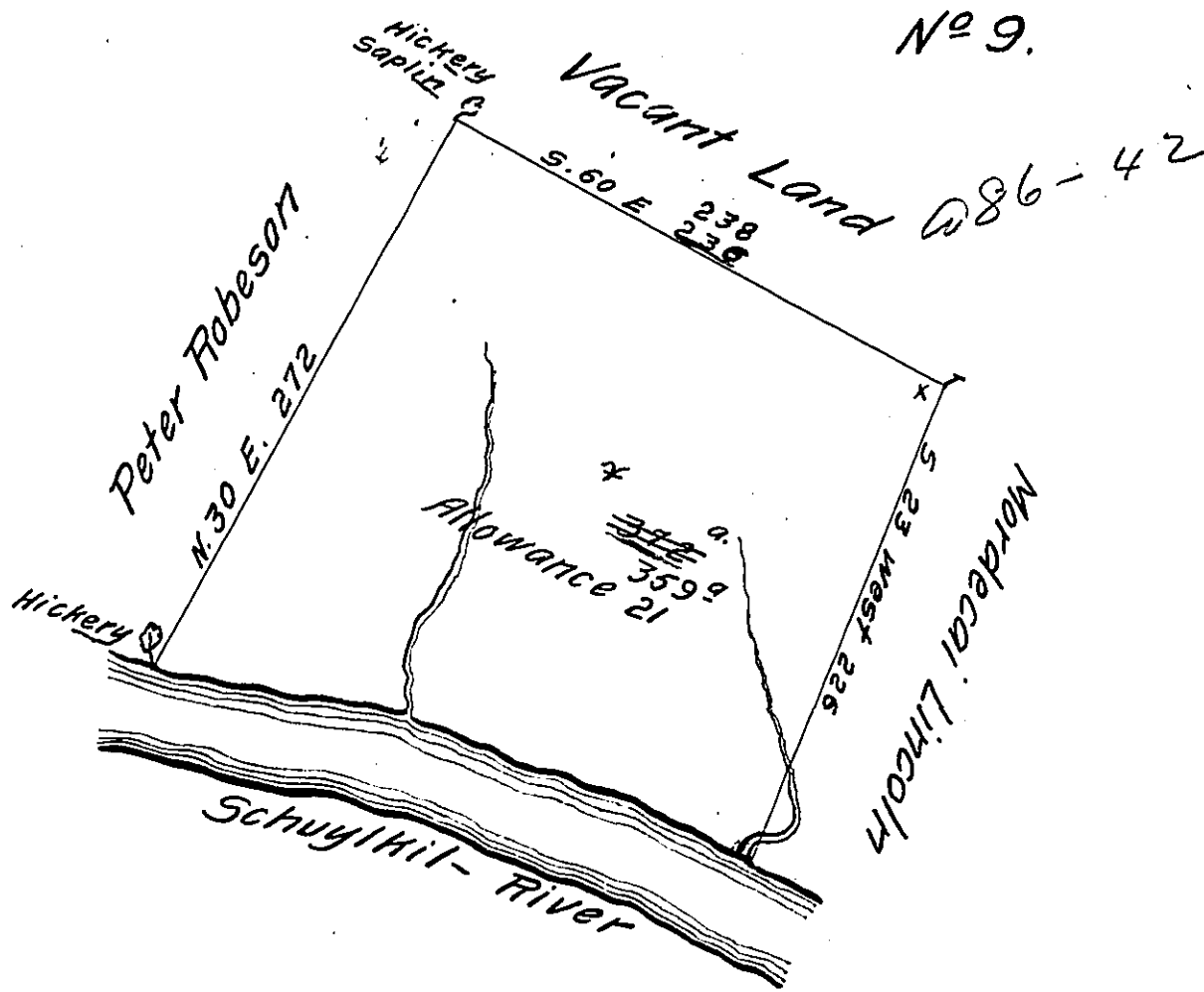

By virtue of a Warrant from \_\_\_\_\_ dated the \_\_\_\_\_ day of \_\_\_\_\_ 1730.

Survey'd to William Allen a Tract of Land situate on the East side of the River Schuylkill in the County of Philad<sup>a</sup> beginning at a hickery tree standing on the bank of the said River being a corner of Peter Robeson's land thence by the same north thirty degrees east two hundred and seventy-two perches to a hickery sapliz another corner of said Robeson's land thence by vacant land south sixty degrees east Two hundred thirty eight perches to a post thence by Mordecai Lincoln's - south twenty three degrees west Two hundred twenty-six perches to a hickery on the bank of y<sup>e</sup> said River being a corner of said Mordecai Lincoln's land thence up the severall courses of the said River Two hundred seventy-four perches to the place of beginning containing three hundred ~~twenty two~~<sup>fifty-nine</sup> acres w<sup>th</sup> allowance of six P. Cent. Surveyed 8<sup>th</sup> 20<sup>th</sup> 1730

Nich<sup>s</sup> Scull -

IN TESTIMONY that the above is a copy of the original remaining on file in the Department of Internal Affairs of Pennsylvania, made conformably to an Act of Assembly approved the 16th day of February, 1833, I have hereunto set my Hand and caused the Seal of said Department to be affixed at Harrisburg, this twelfth day of July 190.

Henry Howell

Secretary of Internal Affairs.